

ALSO SEE DETAIL
VP-2 FOR ISOMETRIC
VIEW.

STANDARD
PREMIUM COAT
ROOF SYSTEM

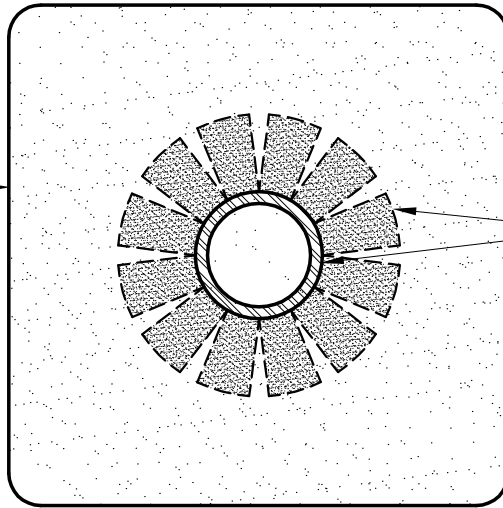

1. REINFORCING
FABRIC PIPE
WRAP

2. 12"x12" REINF.
FABRIC OVER
PIPE WRAP.

PLAN

STORM COLLAR,
IF REQUIRED

FINISH COAT
COMPONENT OVER
ENTIRE ROOF
(4 COATS).

FOUNDATION COAT,
FABRIC, AND
FOUNDATION
COAT COMPONENTS

6"
MIN.

FOUNDATION COAT, 12" FABRIC, AND
FOUNDATION COAT COMPONENTS

PLACE ADDITIONAL LAYERS OF
REINFORCING FABRIC AT PENETRATION
BASE, AS SHOWN ON "PLAN" HERE AND
ON "ISOMETRIC VIEW" ON DETAIL VP2.

FOUNDATION COAT, FABRIC, AND
FOUNDATION COAT COMPONENTS

SECTION

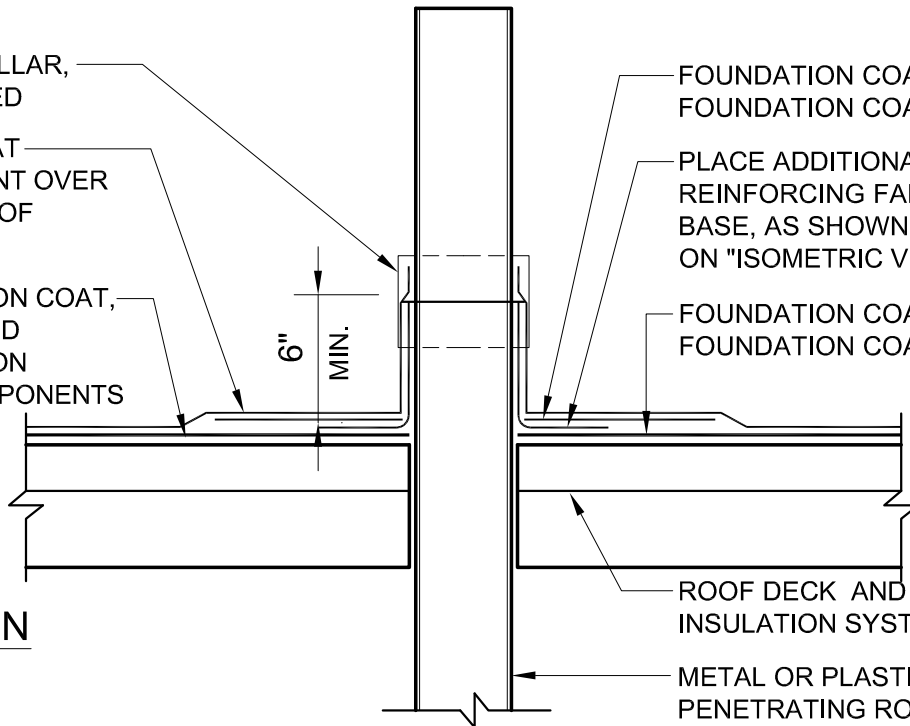

ROOF DECK AND
INSULATION SYSTEM

METAL OR PLASTIC VENT PIPE
PENETRATING ROOF MEMBRANE

NOTES:

1. THIS DETAIL IS A TYPICAL PENETRATION DETAIL APPLICABLE FOR ALL COLD PIPE PENETRATIONS. FOR HOT PIPE PENETRATIONS CONTACT THE MANUFACTURER FOR REQUIREMENTS.
2. FOR PIPE PENETRATIONS THAT EXCEED 18" ABOVE THE ROOF SURFACE A STORM COLLAR SHALL BE USED WITH A DRAW BAND AND CAULKING. THE ROOF COATING SHALL EXTEND 8" (MIN.) UP PENETRATION SURFACE AS INDICATED IN THIS DETAIL.
3. PREMIUM COAT SYSTEM- FOUNDATION COAT, FABRIC, FOUNDATION COAT, AND FINISH COAT COMPONENTS.
4. FOUNDATION COAT- COMBINED COVERAGE (2 COATS) AT MINIMUM RATE OF 40 SF/GALLON.
5. FINISH COAT- COMBINED COVERAGE (4 COATS) AT MINIMUM RATE OF 35 SF/GALLON.
6. PRIMING- REFER TO HYDROSTOP SPECIFICATIONS FOR DECK PRIMING REQUIREMENTS.

**HYDRO
STOP**

PREMIUM COAT SYSTEM

TYPICAL VENT PIPE FLASHING DETAIL

10 YEAR SYSTEM

DATE:

08/30/10

SHEET No :

VP-1-10