

SECTION

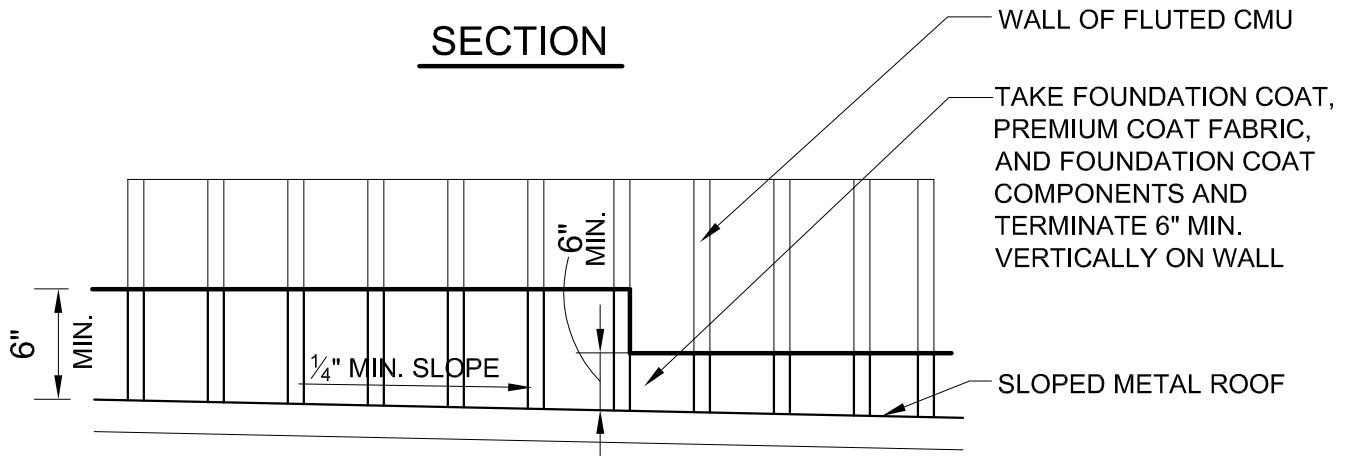

ELEVATION

NOTES:

1. ALL FLASHING SHALL BE DESIGNED FOR THE APPLICABLE CONDITIONS. METAL THICKNESS, FASTENERS, AND LAPPING SHALL BE AS SPECIFIED BY THE ROOF DESIGNER.
2. REFER TO THE SPECIFICATIONS FOR SPECIFIC EXECUTION REQUIREMENTS.
3. PREMIUM COAT SYSTEM- FOUNDATION COAT, FABRIC, FOUNDATION COAT, AND FINISH COAT COMPONENTS.
4. FOUNDATION COAT- COMBINED COVERAGE (2 COATS) AT MINIMUM RATE OF 40 SF/GALLON.
5. FINISH COAT- COMBINED COVERAGE (2 COATS) AT MINIMUM RATE OF 70 SF/GALLON.
6. PRIMING- REFER TO HYDROSTOP SPECIFICATIONS FOR DECK PRIMING REQUIREMENTS.



PREMIUM COAT SYSTEM

ROOF TO WALL DETAIL
10 YEAR SYSTEM

DATE:

08/20/10

SHEET No :

WF-2-10