

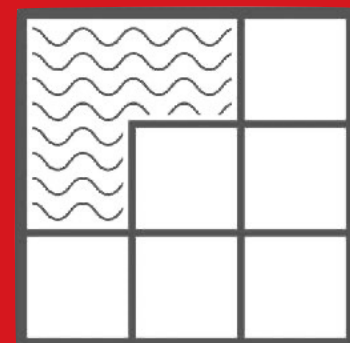

SURFACE SEAL SB

Thermoplastic Rubber | Waterproofing



TILE OVERBURDEN OVER WOOD DECK



GAF SURFACE SEAL SB

Thermoplastic Rubber | Waterproofing



Coverage rates are estimates only. Actual usage will vary by surface and conditions. Refer to Technical Data Sheet for product specific application and surface temperature restrictions.

APPLY

- Solvent-based, cures to form a seamless rubber membrane
- Do NOT apply more than 1.5 gallons per 100 ft² in a single coat.
- APPLICATION SURFACE TEMPERATURE: 40°F - 100°F



STANDARD COLORS

WHITE	GRAY
-------	------

Surface Seal SB over Cement Board attached to Wood Deck

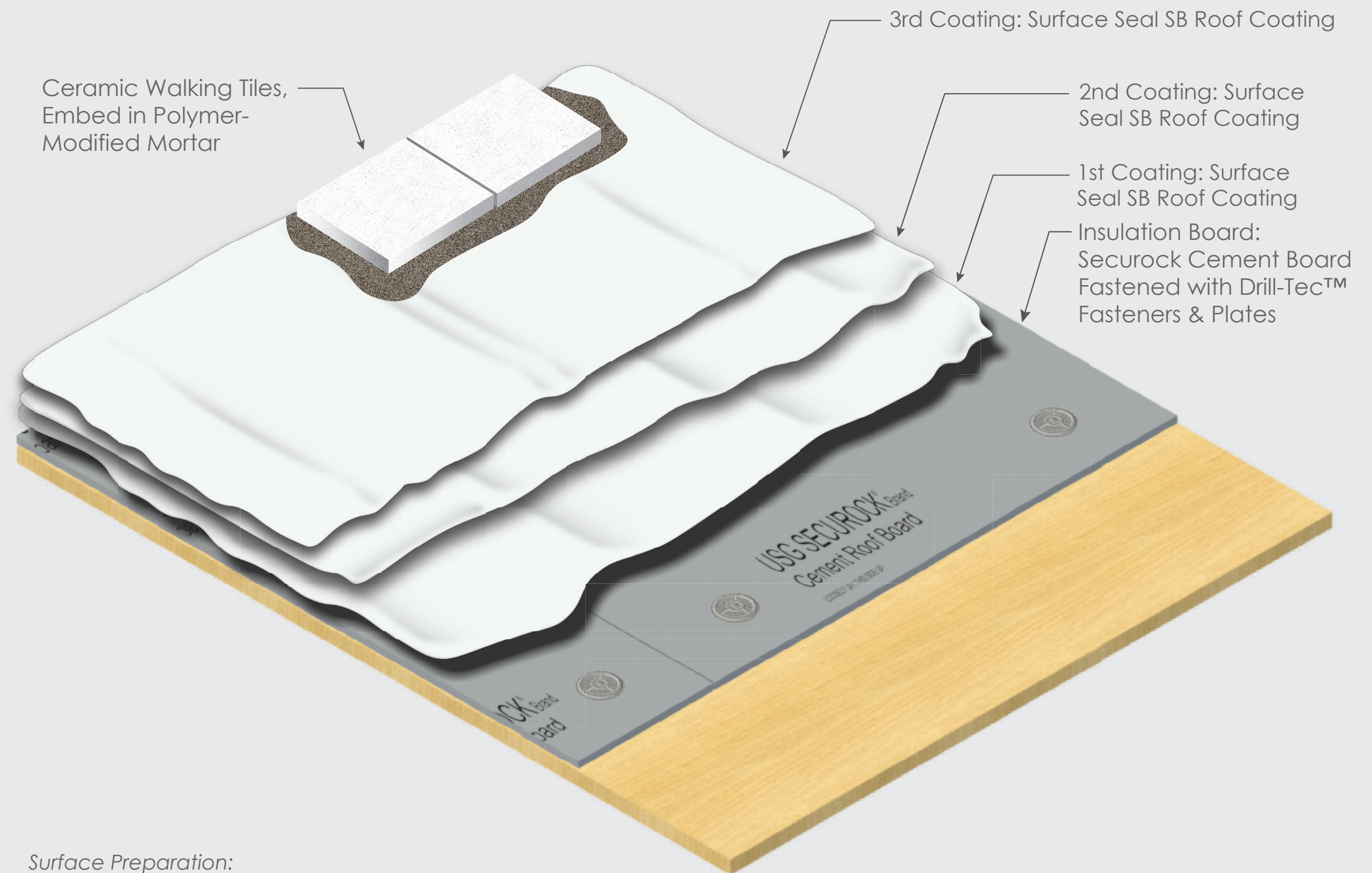

Surface Preparation:
Dry Cleaning Method (Substrate must be clean and dry prior to installing coating materials).

Deck Type: Plywood Deck - 19/32"

Drawing not to scale - The images shown are for illustration purposes only and may not be an exact representation of the products, assemblies, or fastening rates.

10-Year Rate	15-Year Rate	20-Year Rate
3 Gal/Sq	4 Gal/Sq	5 Gal/Sq
24 DFT ² , mils	32 DFT ² , mils	40 DFT ² , mils
1.66 Sq per 5-gal pail	1.25 Sq per 5-gal pail	1 Sq per 5-gal pail

ATTACH

CEMENT ROOF BOARD TO WOOD DECK



SECUROCK® Cement Board:

1/2" x 4' x 8'

1/2" x 4' x 4'

Assembled #14 Screw And Plate (ASAP):

ASAP; 3" steel plate; 4" - Detail 458G

ASAP; 3" steel plate; 5" - Detail 458I

SEAL

REINFORCED SEAMS & DETAILS



Surface Seal SB (Solvent-Based)

89SS920 - Surface Seal SB 5-GAL

Reinforcing Fabrics

890061000 - 6" x 300' GAF Premium Fabric - 75 Rolls / Box

890063000 - 12" x 300' GAF Premium Fabric - 25 Rolls / Box

APPLY



Surface Seal SB (Solvent-Based)

89SS920 - Surface Seal SB 5-GAL

89SD920 - Surface Seal SB 54-GAL

OVERBURDEN

CERAMIC WALKING TILES EMBED IN POLYMER MODIFIED MORTOR



over Wood Deck with Tile Flooring

FASTENING PATTERN SPECIMENS

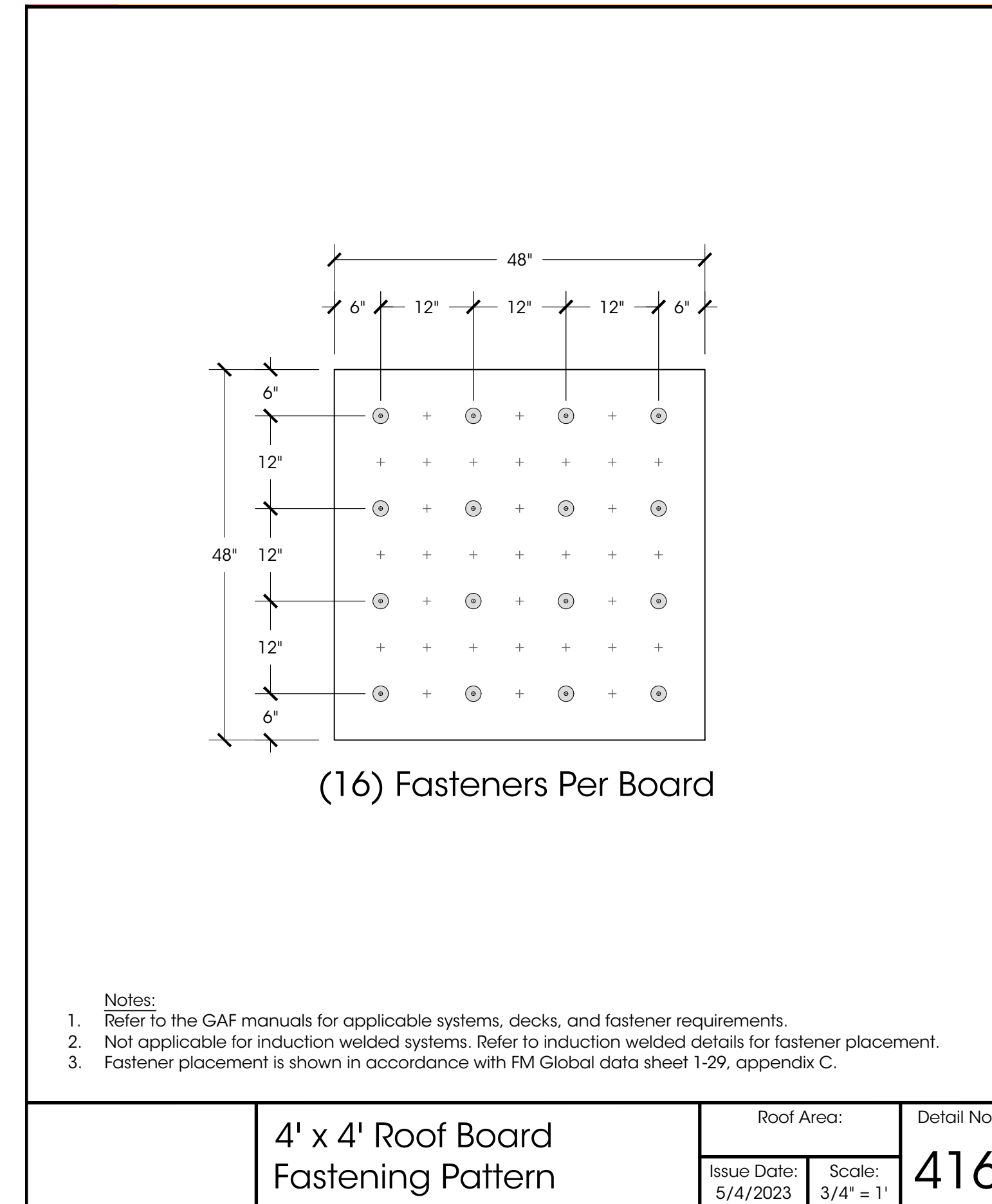
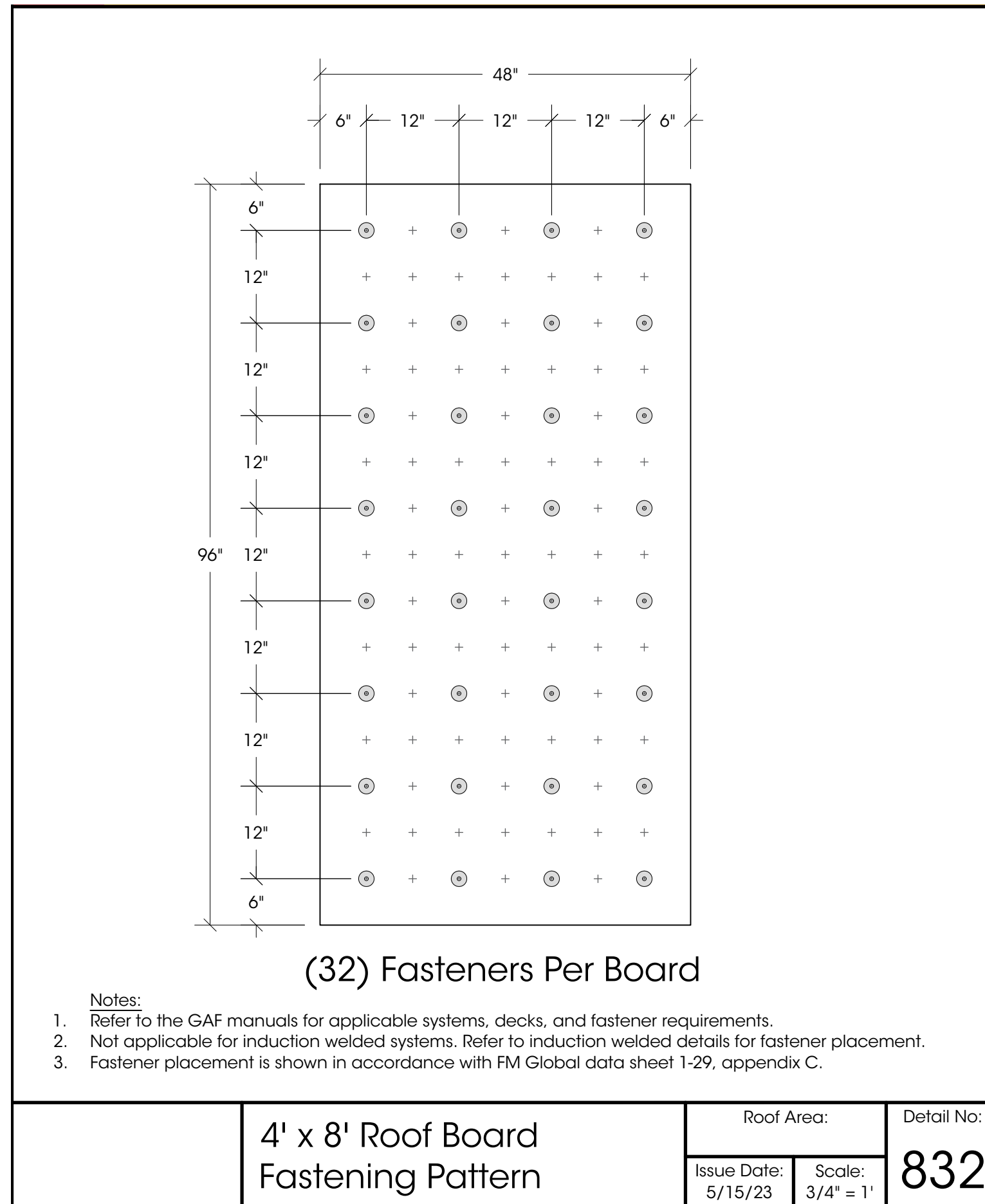

Architectural Detail Drawings

See GAF Liquid Applied Manual for Complete Listing of Architectural Detail Drawings [CLICK HERE](#)

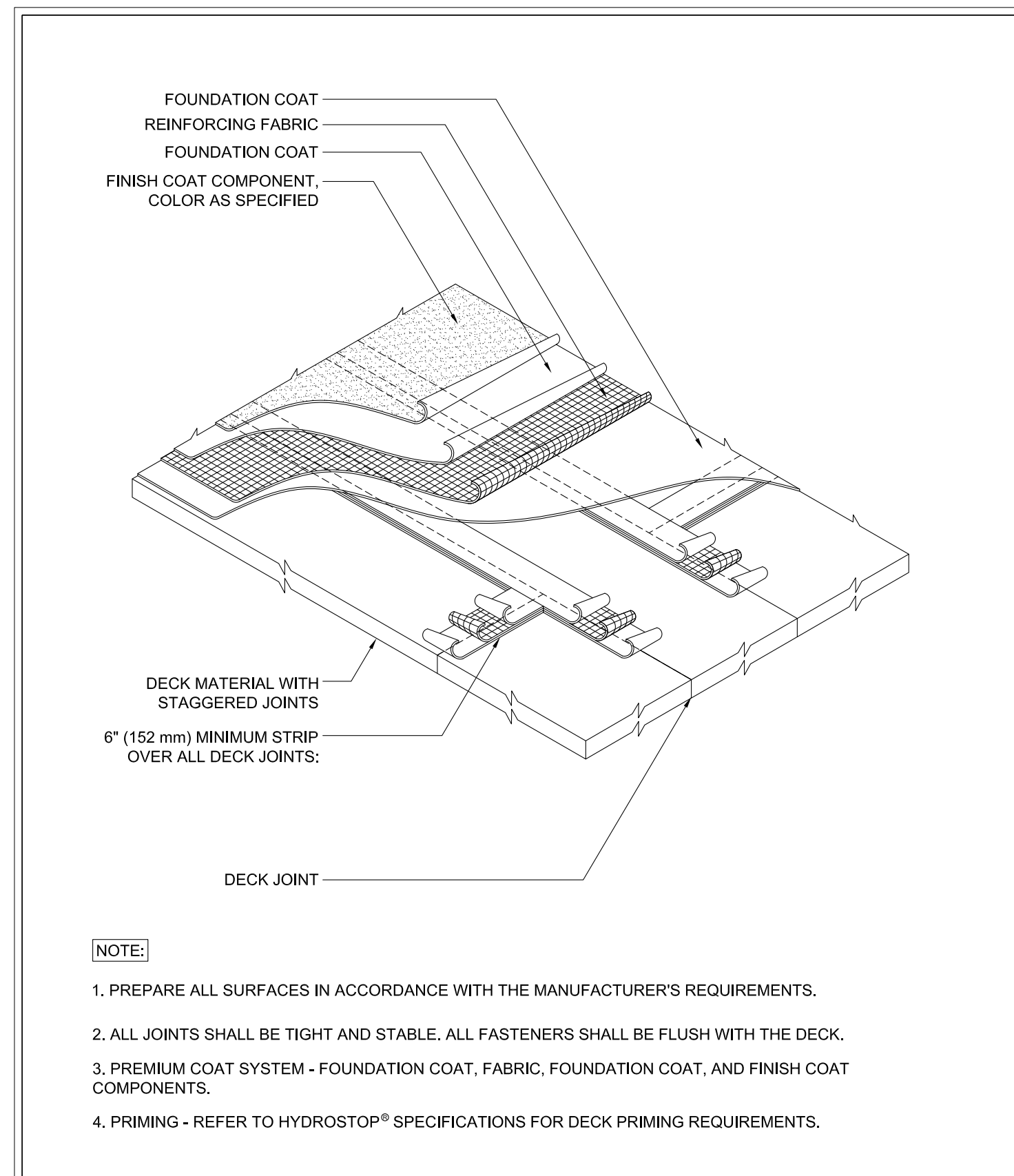

 <small>www.gaf.com 1 Campus Drive Parsippany, NJ 07054</small>	DECK JOINT STRIPPING DETAIL	SYSTEM HS	DRAWING # 104
	FIELD OF ROOF SERIES	SCALE N.T.S.	ISSUE/ REVISION DATE 6-1-16

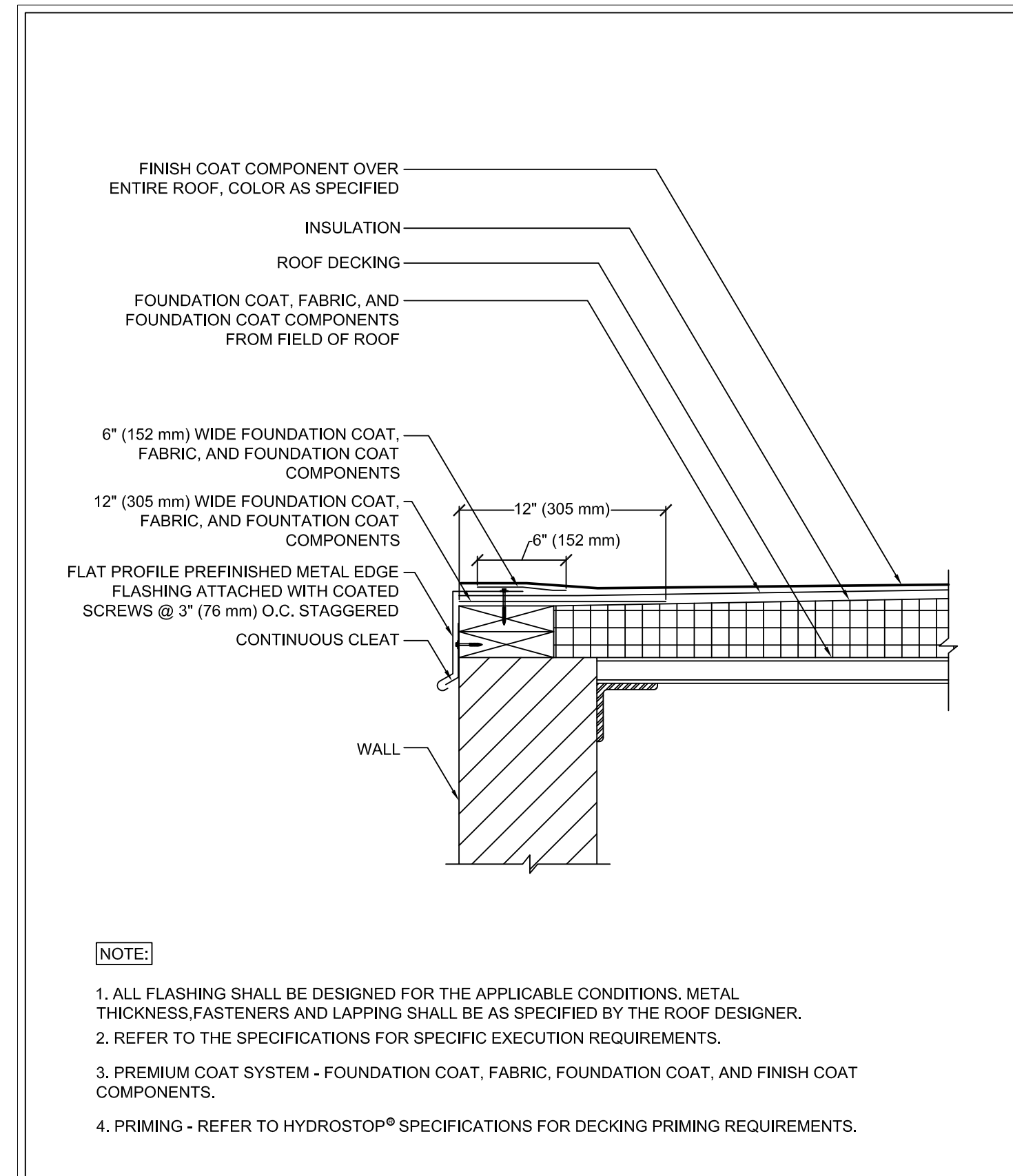

 <small>www.gaf.com 1 Campus Drive Parsippany, NJ 07054</small>	HYDROSTOP	STANDARD DRIP EDGE DETAIL	SYSTEM HS	DRAWING # 201
	ROOF EDGE SERIES		SCALE N.T.S.	ISSUE/ REVISION DATE 6-1-16

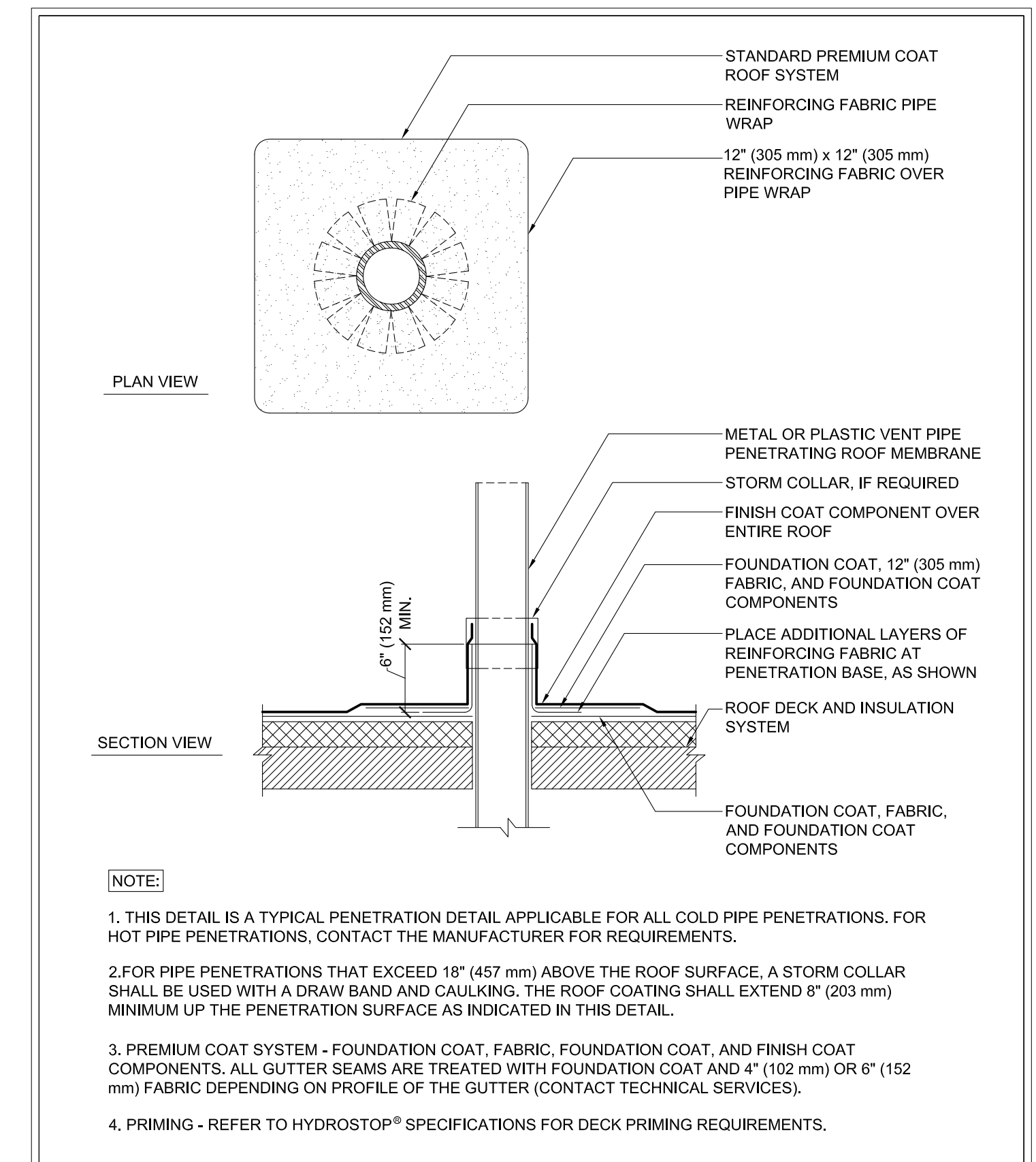

 <small>www.gaf.com 1 Campus Drive Parsippany, NJ 07054</small>	HYDROSTOP	VENT-PIPE FLASHING DETAIL	SYSTEM HS	DRAWING # 502
	ROOF PENETRATION SERIES		SCALE N.T.S.	ISSUE/ REVISION DATE 6-1-16



LIQUID-APPLIED

ROOFING & WATERPROOFING



Daniel Peña

GET PEACE OF MIND WITH A GAF PRO

305.812.6865

daniel.pena@gaf.com



Photo taken at #WALLOFWIND

There's a liquid solution for your roof - talk to GAF first